

INTRODUCING THE NEXT GEN CLASS 5 INTERCHANGEABLE TRUCK BODY SYSTEM*

FITS CLASS 5 FORD, RAM, AND CHEVY
60" CA STRAIGHT FRAME CHASSIS

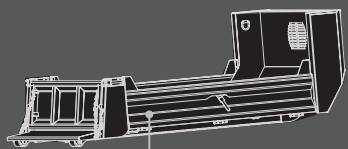

DUMP BODY

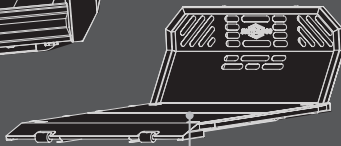

FLATBED BODY

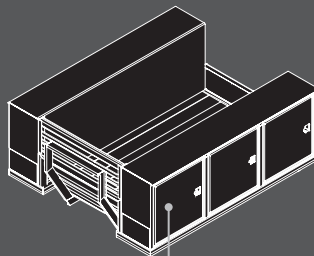

SERVICE BODY

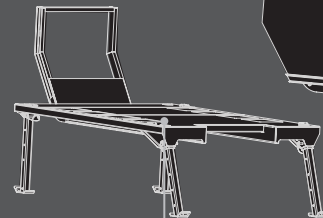

WORKREADY™ SUBFRAME

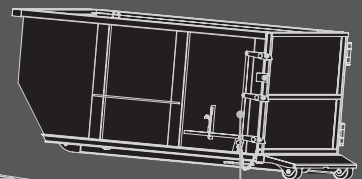

DROP BOX

Center of Gravity
Issues Solved

Safe Loading
and Load
Management

Patents
Pending

DESIGN MATTERS

OUR CLASS 5 60" CA INTERCHANGEABLE TRUCK BODY SYSTEM WAS DESIGNED WITH SAFETY AND LONGEVITY IN MIND



CHALLENGES WITH COMMON BODY DESIGNS

OUR PATENT PENDING 60" CA SOLUTION



FULL LENGTH 9' BODY ON 60" CA CHASSIS*

Significant amount of payload rests behind rear axle. Poor center of gravity which reduces legal payload.



APRON BODIES SHIFT THE LOAD FORWARD

Payload is moved 1' closer to truck cab. Center of gravity is significantly better, allowing for more legal payload.

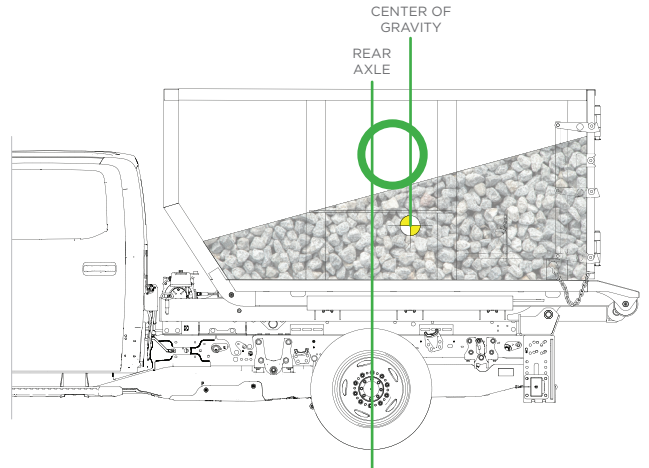
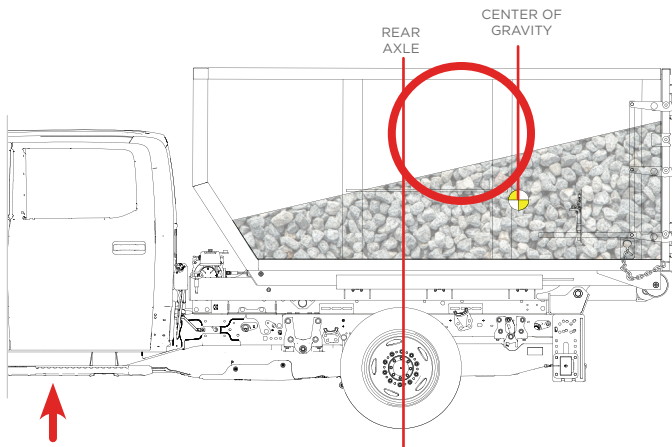

SHORT BODIES TIP WHEN LOADED

8' body length causes tipping when bodies are loaded/unloaded.



8' BODY WITH 1' APRON ON 60" CA CHASSIS*

New apron design keeps the body contacting the ground for a smooth load/unload.

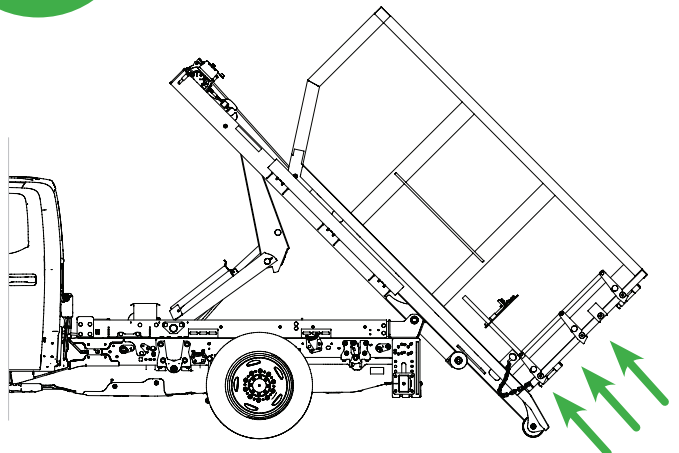
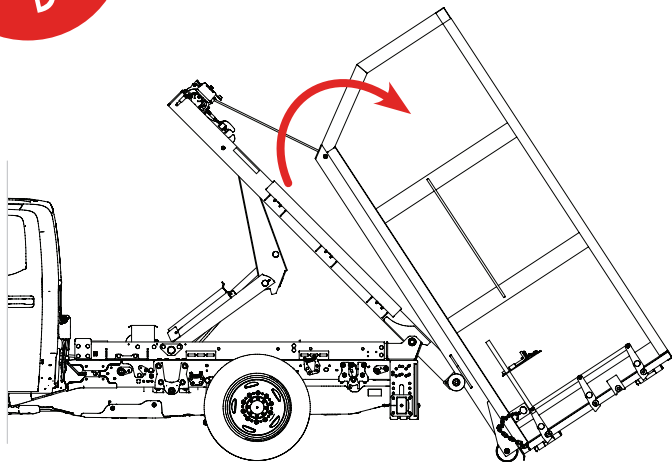

*These two diagrams show the payload configuration after it has been loaded from ground level.